

JARDIM ANTUÉRPIA

PROPRIETÁRIOS: DALTON DELFIM E ALFREDO F. PIMENTEL
 PRESIDENTE PRUDENTE
 ESCALA 1:1000

24480
 Paulo E. R.
 1.10.01.09

Di.
 (+)

RUA ANTUÉRPIA

1	2	3	4	5	6	7
2200	2200	2200	2200	2200	2200	2200
1100	1100	1100	1100	1100	1100	1100

RUA VENEZUELA

1	2	3	4	5	6	7	8
2200	2200	2200	2200	2200	2200	2200	2200
1100	1100	1100	1100	1100	1100	1100	1100

RUA VICENTE DE CARVALHO

1	2	3	4	5	6	7	8	9	10	11
2200	2200	2200	2200	2200	2200	2200	2200	2200	2200	2200
1100	1100	1100	1100	1100	1100	1100	1100	1100	1100	1100

RUA AMARAL

1	2	3	4	5	6	7	8
2200	2200	2200	2200	2200	2200	2200	2200
1100	1100	1100	1100	1100	1100	1100	1100

RUA BONFALVES

1	2	3	4	5	6	7	8	9	10	11	12	13	14	15
2200	2200	2200	2200	2200	2200	2200	2200	2200	2200	2200	2200	2200	2200	2200
1100	1100	1100	1100	1100	1100	1100	1100	1100	1100	1100	1100	1100	1100	1100

RUA SONDALVAL FILHO

1	2	3	4	5	6	7	8	9	10	11	12	13	14	15	16	17	18	
2200	2200	2200	2200	2200	2200	2200	2200	2200	2200	2200	2200	2200	2200	2200	2200	2200	2200	2200
1100	1100	1100	1100	1100	1100	1100	1100	1100	1100	1100	1100	1100	1100	1100	1100	1100	1100	1100

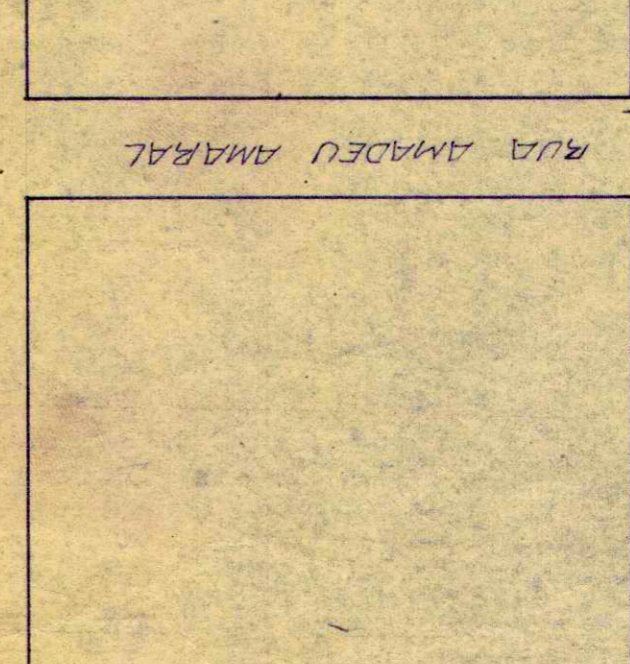
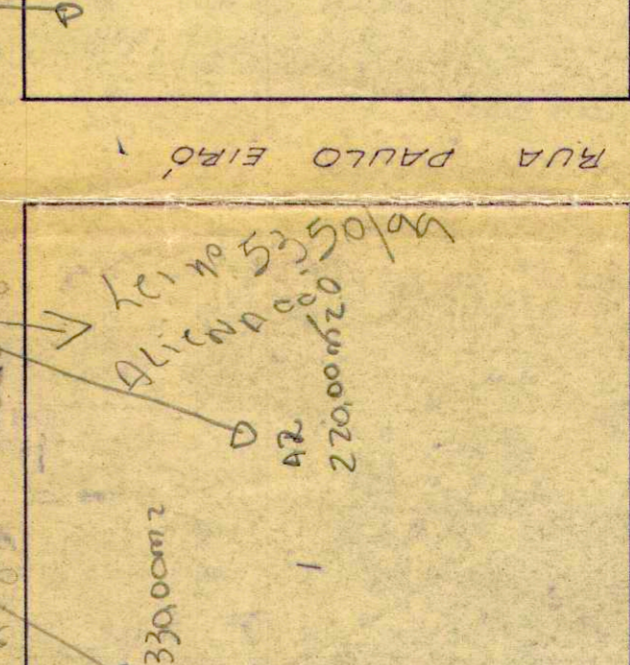
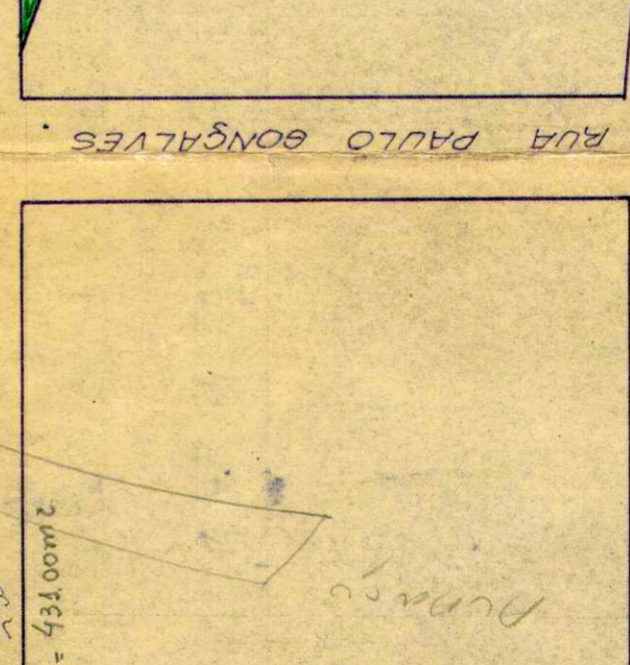
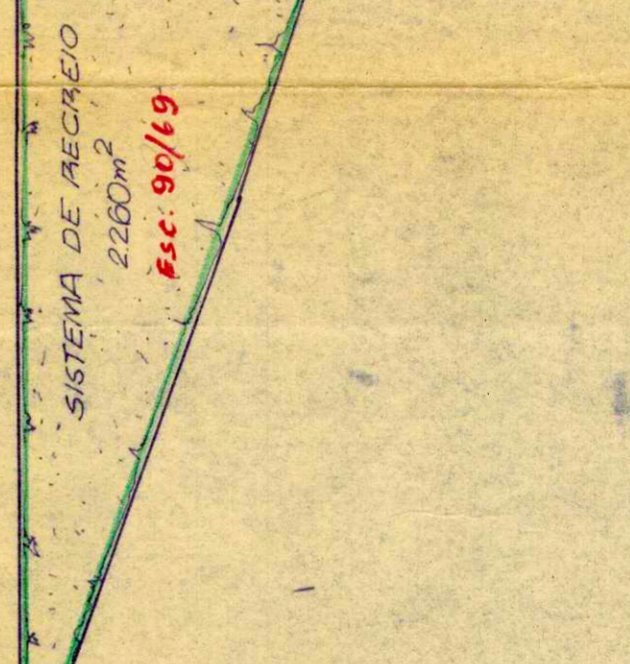
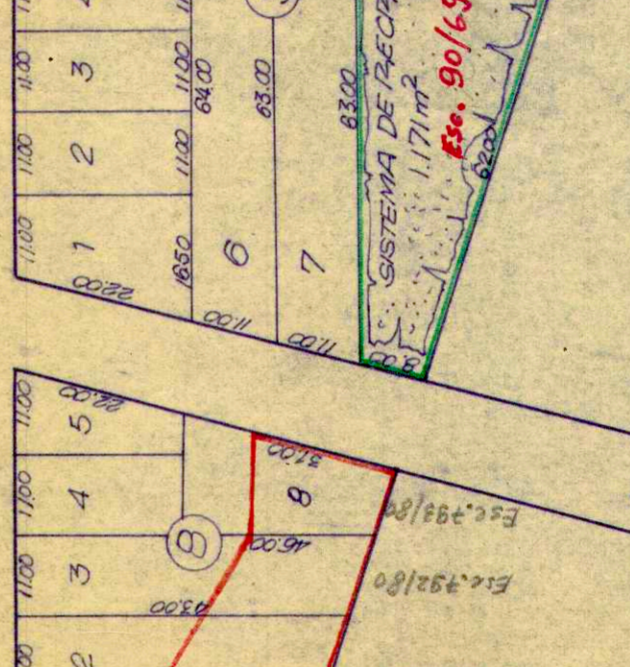
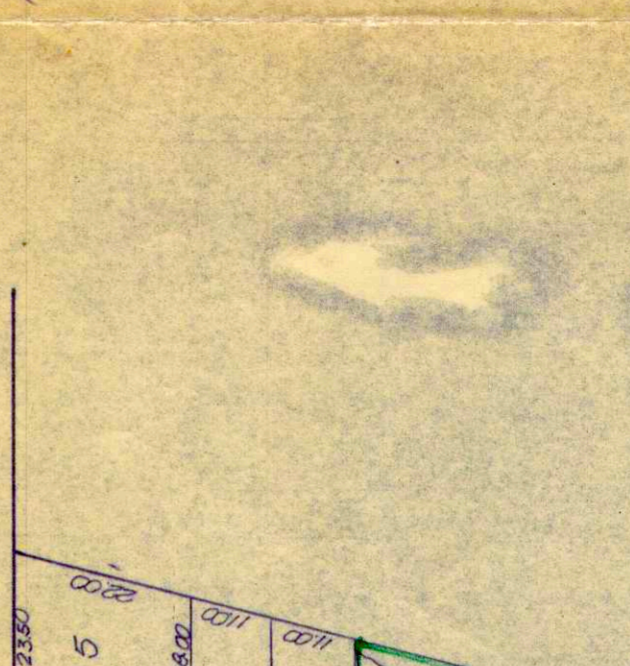
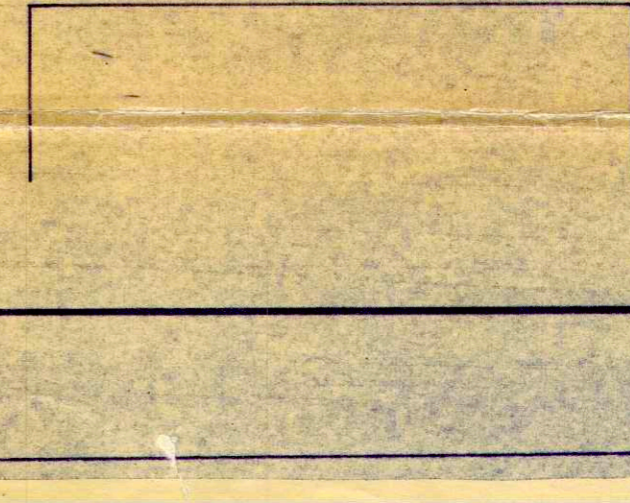
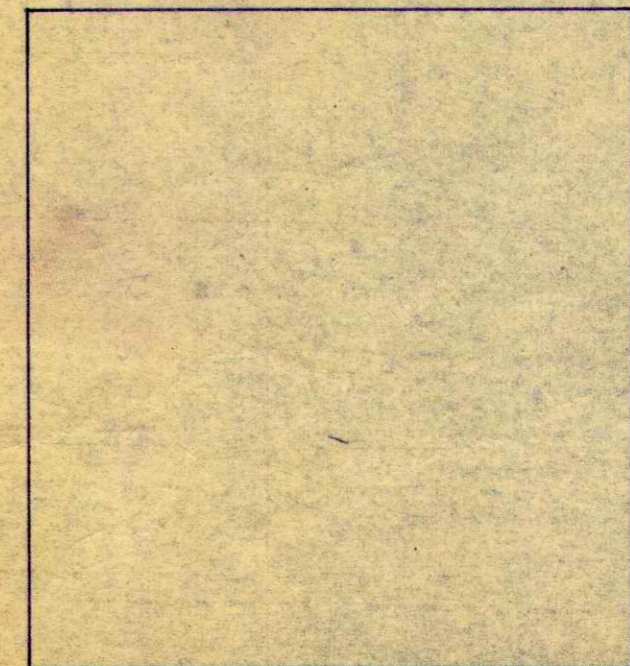
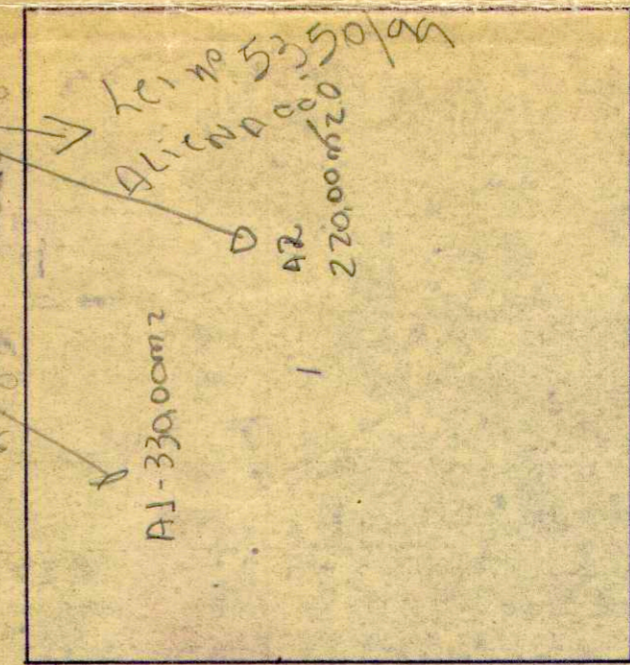
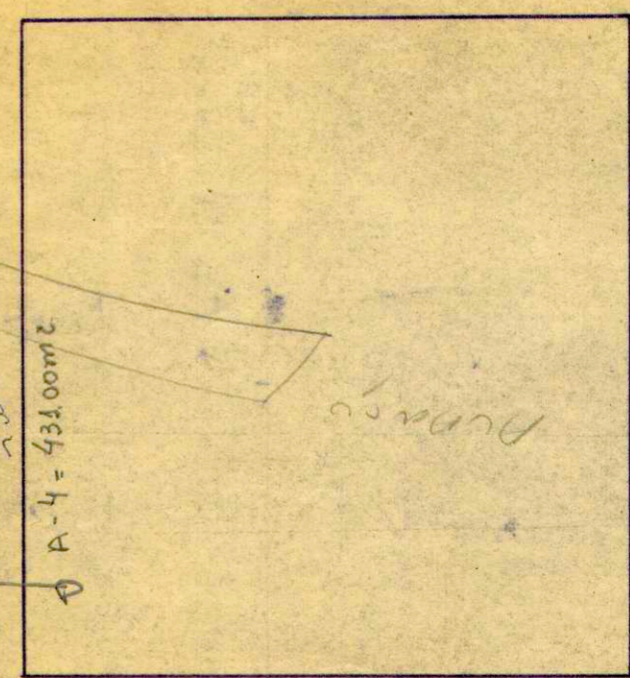
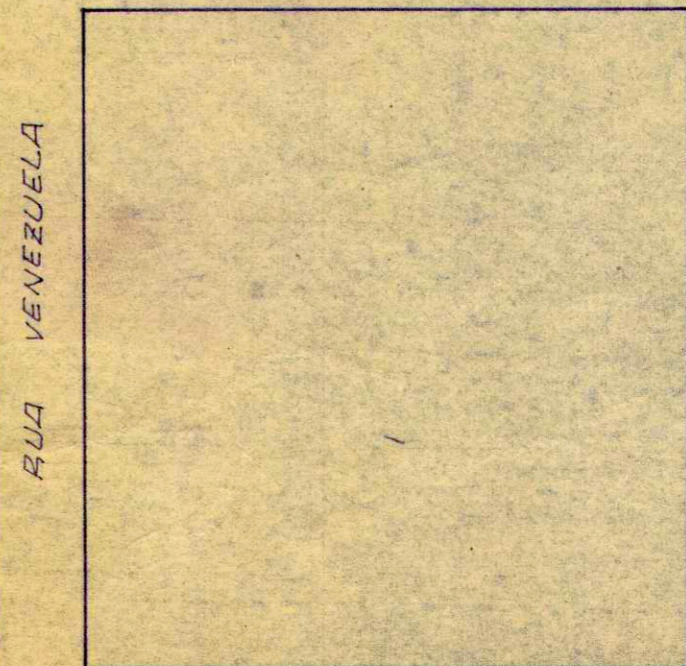

Distrito 636
 Prefeitura Municipal de Presidente Prudente
 D. O. V.
 Projeto: Cópia fiel da planta do JARDIM ANTUÉRPIA, arquivada da no D.O.V. de acordo pelo Prefeito Municipal em 20/07/69. Escala: indicada
 Data: 6/5/70
 ENGENHEIRO
 DISENHEIRO

SITUAÇÃO

