

Quadra	Lotes	Area (m ²)	Total (m ²)
L	1	53,39	4.430,68
	2 a 6	258,00	
	9 a 13	264,36	
	7	355,84	
	8	543,55	
	14	358,10	
	1	470,54	
M	2 a 6	252,00	4.154,84
	7	344,28	
	8	470,64	
	9 a 13	252,00	
	14	344,28	
	1	470,64	
	2	252,00	

Curva	AC	D(m)	T(m)	A(m ²)
C1	71°15'	7,46	4,30	3,42
C2	108°45'	11,39	8,37	16,05
C3	108°28'	11,36	8,33	15,90
C4	70°17'	7,36	4,22	3,24
C5	110°00'	11,52	8,57	16,86
C6	70°00'	7,33	4,20	3,22

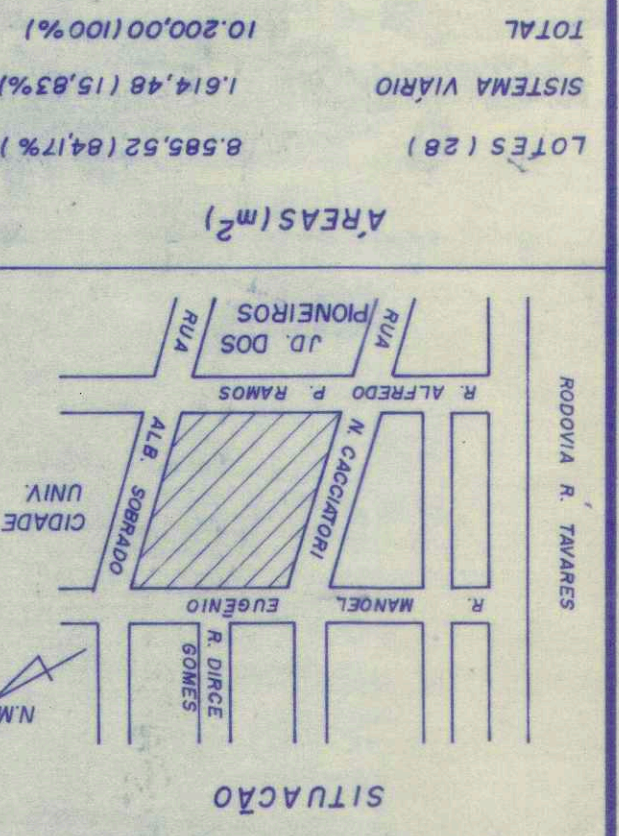
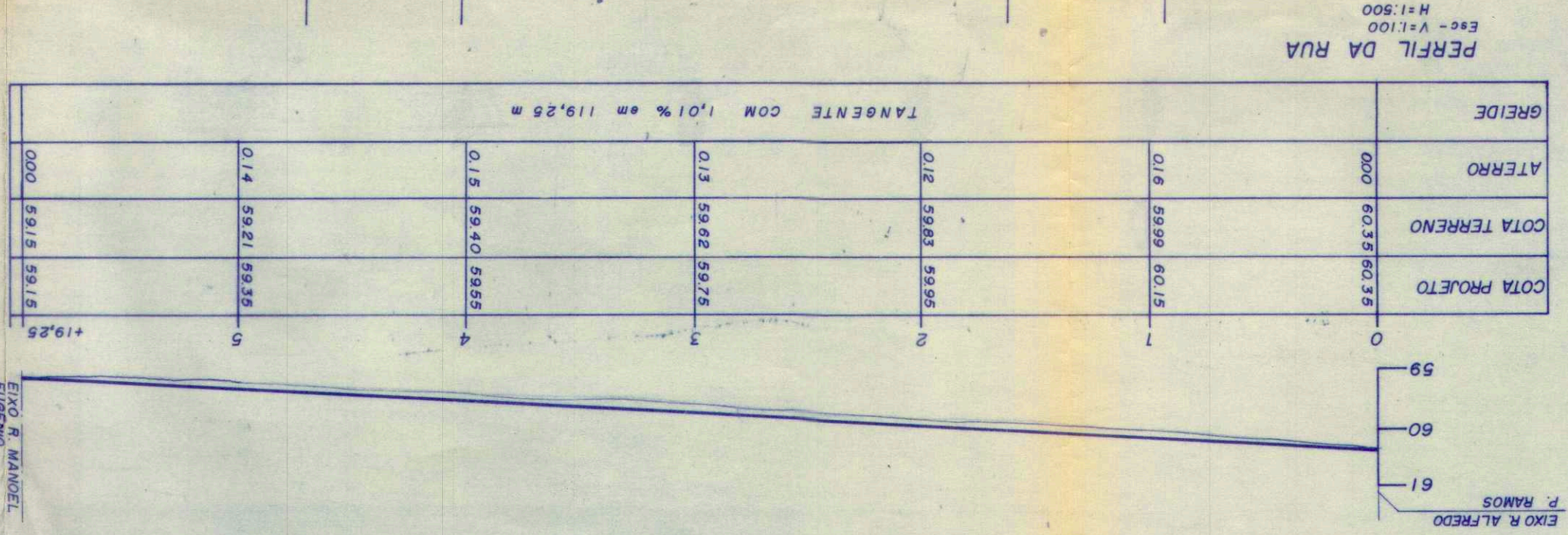
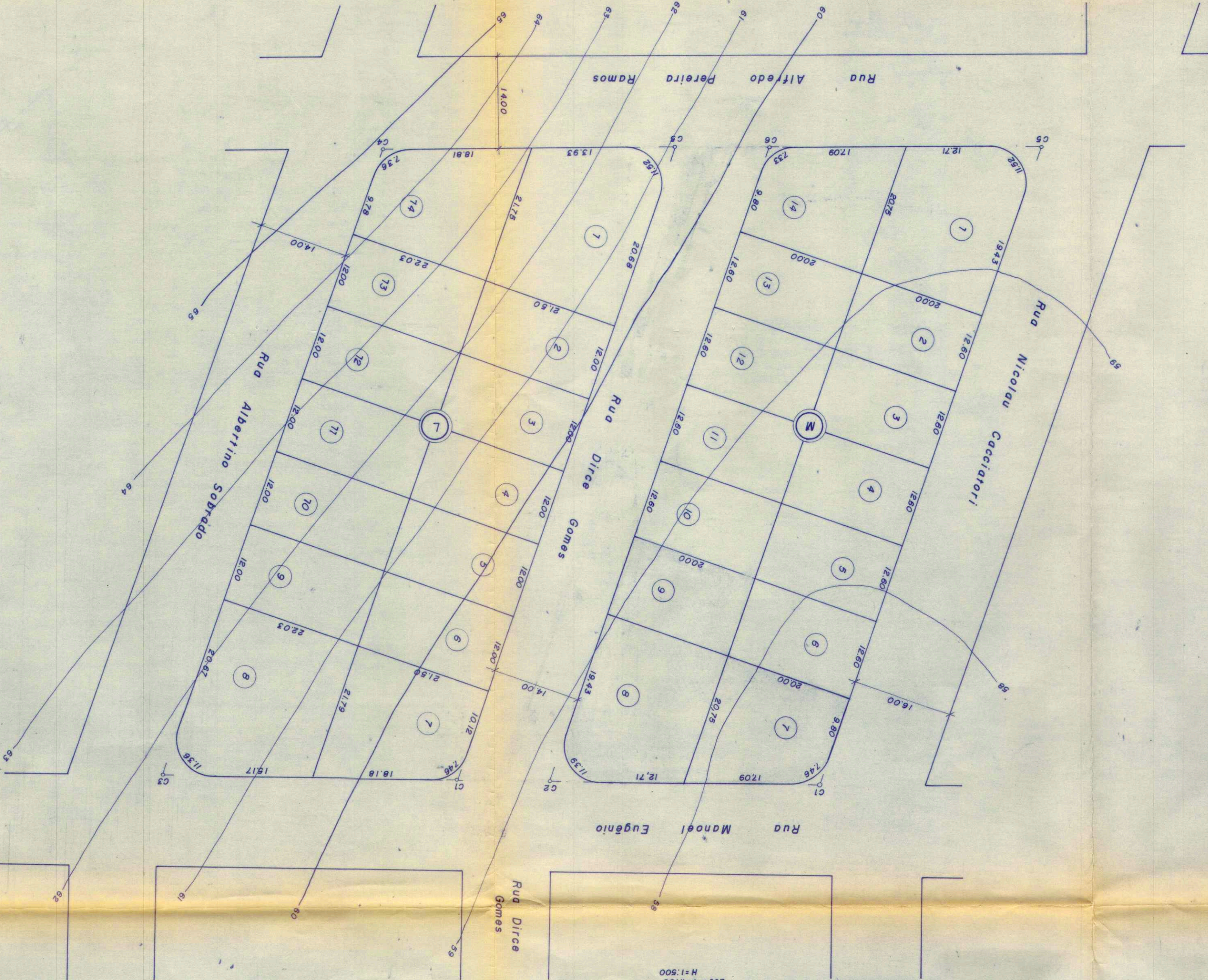
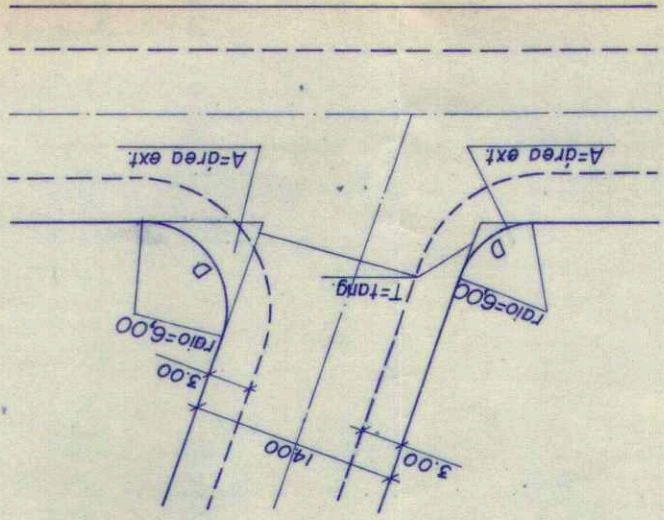
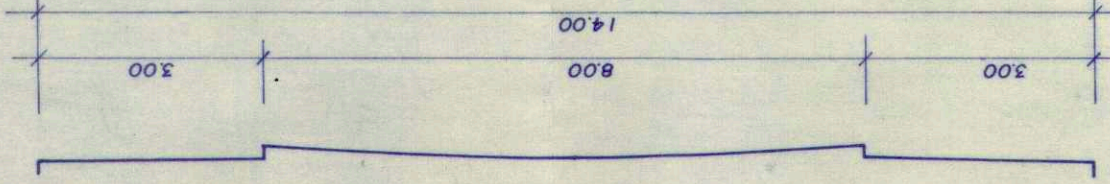

LOTES (28) 8,585,52 (64,17%)
 SISTEMA VIÁRIO 1,614,48 (15,83%)
 TOTAL 10.200,00 (100%)

ART-177/55
 Eng. Resp. - Marcão Alberto Manoel
 ENG. CIVIL - CREA/SP 145623/D

PROJETO: LOTEAMENTO URBANO (RESIDENCIAL)
 PROPRIETÁRIO: PREFEITURA MUNICIPAL DE PRESIDENTE PRUDENTE
 ENDEREÇO: AVENIDA CORONEL MARCONDES 1.200
 BAIRRO: JARDIM DOS PIONEIROS
 CIDADE: PRESIDENTE PRUDENTE
 ESCALA: 1:500

PROJETO COMPLETO
 FOLHA ÚNICA
 P.M. 1987

APPROVADO
 Prefeitura Municipal "Papo Fortalido Loai"
 Assessoria de Planejamento
 Diretor J. A. Pantarotto
 DEFERIDO
 Prefeitura Municipal "Papo Fortalido Loai"
 Assessoria de Planejamento
 Presidente Prudente, 11 de 1989